

Health Craft™ INSTALLATION INSTRUCTIONS

SuperPole “Traveller”

Supplementary Instructions for SuperPole Traveller middle joint assembly

Complete the following assembly work, and then proceed with SuperPole installation instructions

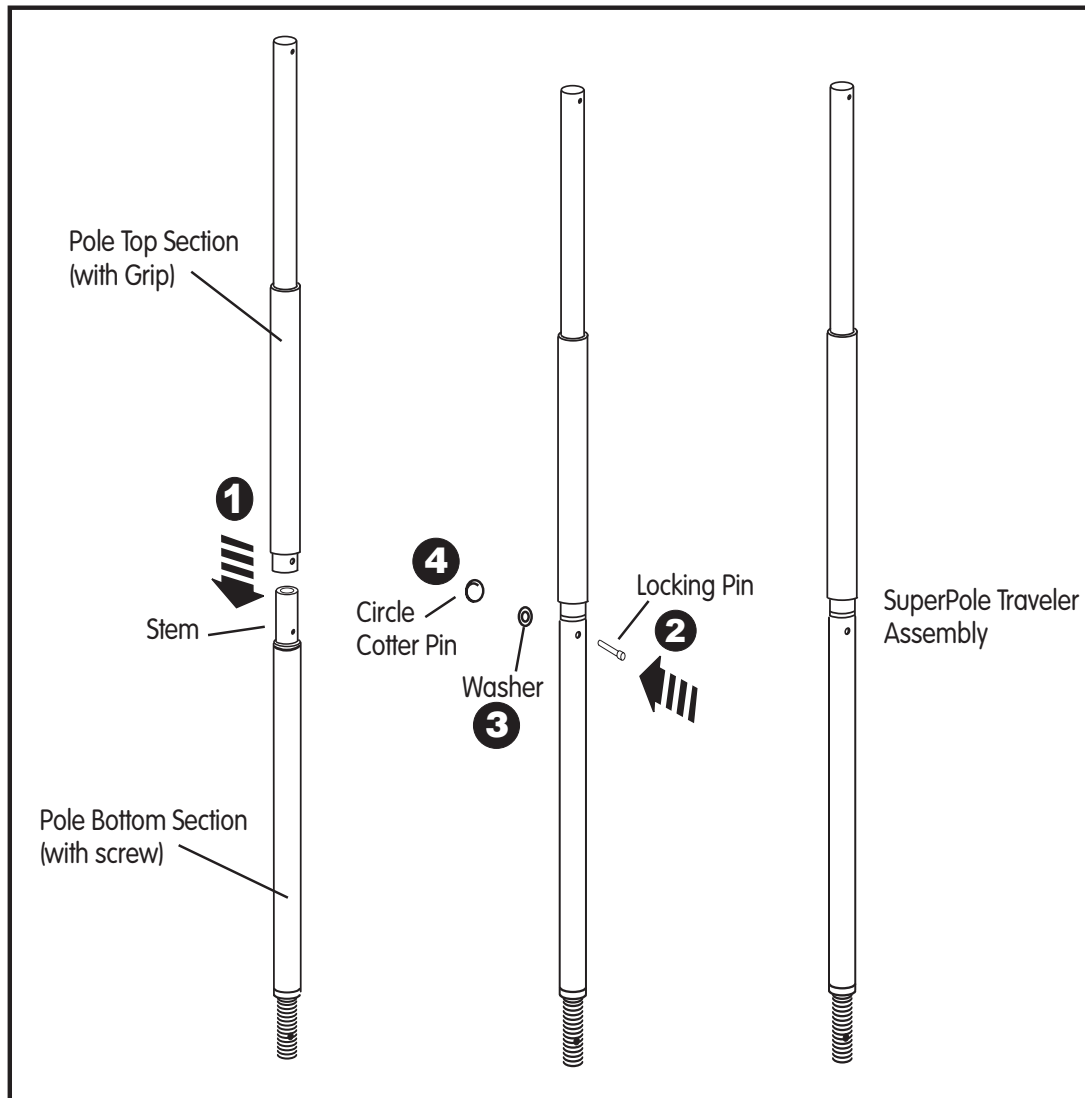

1. Insert stem of pole bottom section into bottom of pole top section as shown. Rotate poles such that thru-holes line up.
2. Insert locking pin through holes as shown
3. Add nylon washer onto locking pin as shown
4. Insert circle cotter pin through hole in end of locking pin

Install SuperPole assembly following SuperPole installation instructions.



IMPORTANT - Always secure joint with locking pin and cotter pin