

THANK YOU...

Thank you for purchasing the Revo™ Patient Turner. We are confident that you will find the unique design and durable construction of this HealthCraft™ product to be of great assistance in your daily routine.

To fully enjoy your Revo™ Patient Turner, please take a few moments to read these instructions. You should store these instructions in a safe place for future reference.

SAFETY CONSIDERATIONS

CAUTION: It is your responsibility to see that your Revo™ Patient Turner is properly assembled and cared for. Failure to follow instructions in this manual could result in serious injury.

REVO™ PATIENT TURNER MAINTENANCE

The Revo™ Patient Turner has a recommended weight limit is 300lbs/136kg. **WARNING:** Failure to comply with any of the cautions may result in one or more of the following:

1. Injury to the patient.
2. Injury to the caregiver.
3. Damage to the Revo™ Patient Turner.

- ⚠ The Revo™ Patient Turner base plate must be locked at all times, unless revolving patient under caregiver guidance.
- ⚠ Immediately lock the Revo™ Patient Turner base plate when the revolve is complete.
- ⚠ Caregiver **MUST** hold the handle bars when patient is rising and lowering.
- ⚠ Do not use the Revo™ Patient Turner to transport patients - the wheels are solely intended to reduce effort needed to move the (unloaded) Revo™ Patient Turner into place.
- ⚠ Check that all knobs are tight prior to each use. Movement of the handle and kneepad shuttle should not be possible when knobs are tight.

WARRANTY

All HealthCraft™ Products are covered by a one year limited warranty with the exception of hand grips which are subject to normal wear. Buyer hereby indemnifies, agrees to hold harmless and defend HealthCraft™ Products Inc. from and against any and all liabilities, claims, (founded and unfounded), losses, damages, costs and expenses (including without limitation consequential damages and reasonable professional fees) resulting from buyers specification, application, or improper use of goods described hereon; buyers omission or neglect.

HealthCraft™ Products Inc. does not assume any liability for damage resulting from services performed by others or faulty installation, misuse or misapplication of goods sold by HealthCraft™ Products Inc.

HealthCraft™ Products Inc. shall not be liable for prospective profits or special, indirect, or consequential damages, or for the cost of any corrective work done without HealthCraft™ Products Inc. prior approval. HealthCraft™ Products Inc. total liability hereunder shall in no event exceed the purchase price of the goods specified hereon.

The HealthCraft REVO™ Patient Turner is manufactured under license from Parsons ADL and the Parsons EZ TURN II brand.

RVO-S: REVO™ PATIENT TURNER

The Revo™ Patient Turner is an upright, portable patient transfer device developed to allow an assisted transfer from one seated position to another. It is outfitted with superior quality fittings to meet the demands of today's facilities.

The heavy-duty frame, adjustable knee pads and ultra smooth transfer disc allows patients to make use of their available strength while also promoting the reduction of caregiver strain. It allows for a safe and controlled pivot transfer which reduces the weight borne by the caregiver when transferring the patient.

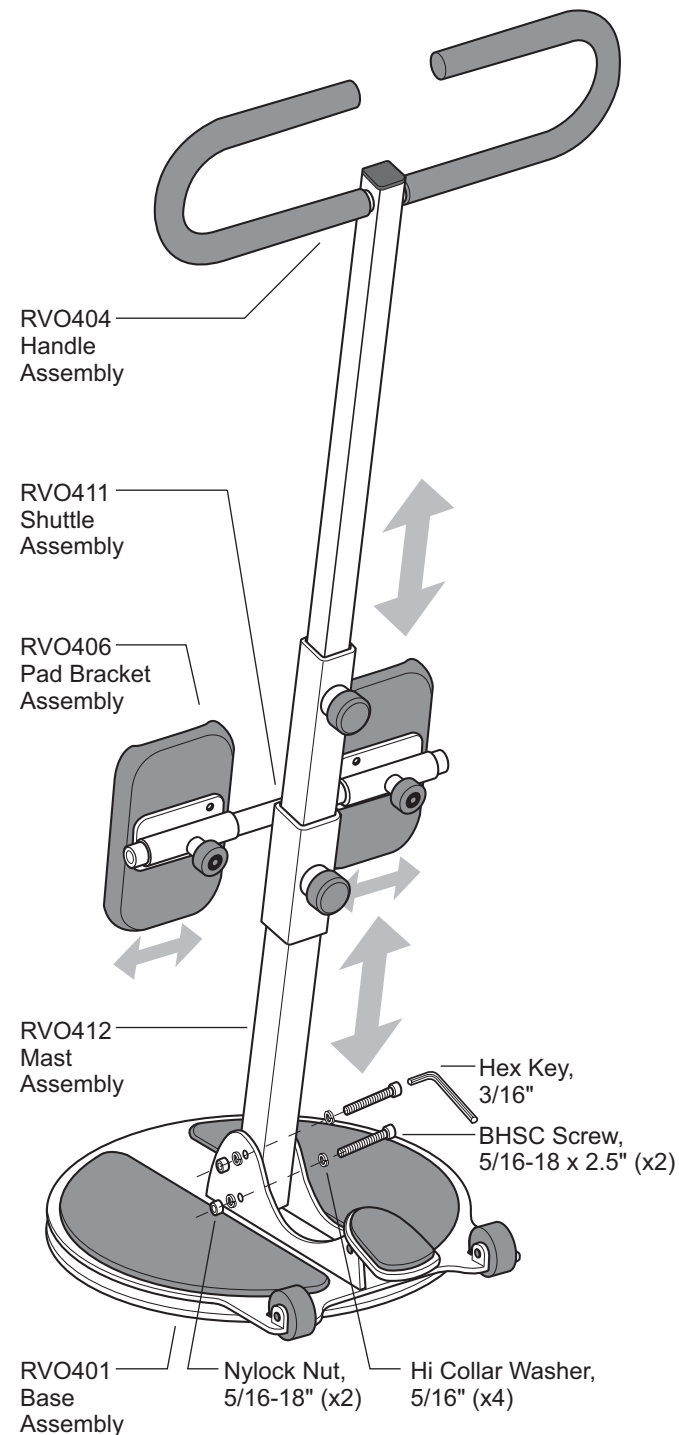

ASSEMBLY INSTRUCTIONS

1. Remove the lock nut (1), washer (2), and bolt (3) from the base bracket (4) using the hex key (5) as shown in **Figure 1a**.
2. Remove the mast (6) from the base bracket (4).
3. Raise the mast (6) as shown in **Figure 1b**, ensuring that the handle knobs (7) are on the same side as the brake pedal (8).
4. Align the holes and fix the mast (6) to the base bracket (4) with the bolts (3), washers (2), and lock nuts (1) using the hex key (5), as shown in **Figure 1c**.
5. To adjust the heights of the handle (9) and shuttle (10), turn the handle knobs (7) counter clockwise as shown in **Figure 2**. This will allow them to move up and down the mast (6).
6. To set the heights of the handle (9) and shuttle (10), turn the handle knob (7) clockwise as shown in **Figure 2** to secure them to the mast.
7. To adjust the widths of the knee pads, pull the spring knob (11) on the pad bracket (12) out (**Figure 3a**), slide pad bracket along the shuttle (10) until it "clicks" into the next locking position.

Your Revo™ Patient Turner is now assembled.

OPERATION INSTRUCTIONS

1. Adjust the height of the handle and the kneepads, and the width of the kneepads to suit the patient.
2. Move the Revo™ Patient Turner in place between the patient and where they need to be as shown in **Figure 4a**.
3. Step on the brake pedal to lock the base plate.
4. Caregiver must hold the upper handle bars as the patient puts their knees against the kneepads and pulls themselves up using the lower handle bars, as shown in **Figure 4b**.
5. Unlock the base plate and revolve the patient. Securely hold the handle bars at all times, as shown in **Figure 4c**.
6. Step on the brake pedal to lock the base plate.
7. Hold the upper handle bars as the patient lowers, as shown in **Figure 4d**.

Figure 1a.

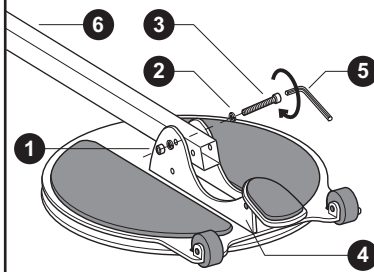

Figure 1b.

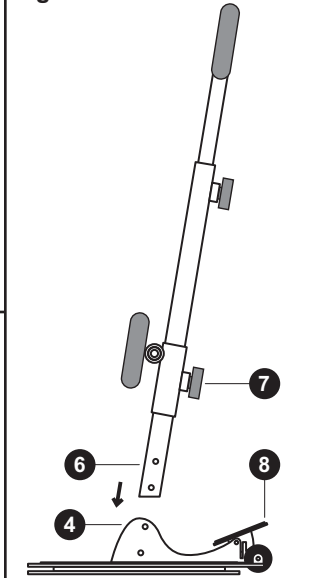

Figure 1c.

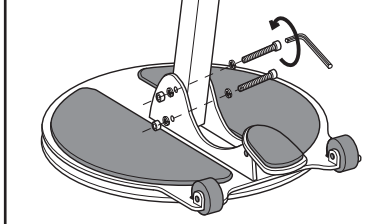

Figure 2.

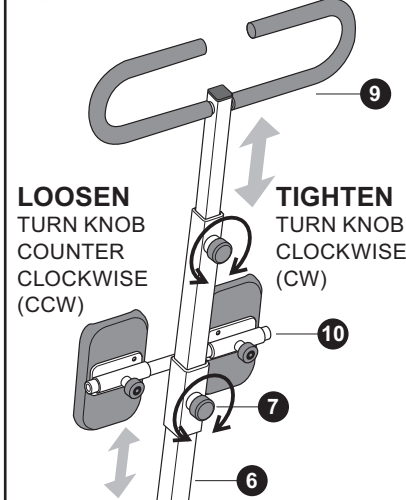

Figure 3a.

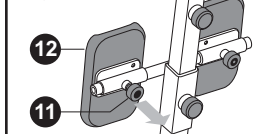

Figure 3b.

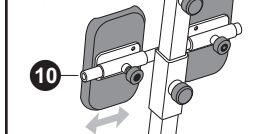

Figure 3c.

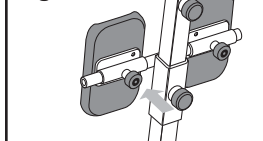

Figure 4a.



Brake pedal LOCKED.

Position Revo™.



Figure 4b.



Brake pedal remains LOCKED.

Patient lifts self.

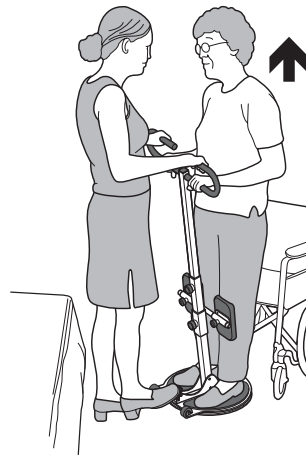

Figure 4c.



Brake pedal UNLOCKED.

Caregiver turns patient.

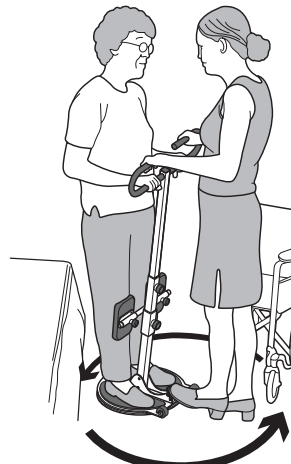

Figure 4d.



Brake pedal LOCKED.

Patient lowers self.

